



Electro-pneumatic drilling units Elektropneumatische Bohreinheiten

| | | |
|---|-------------------------|----------|
|  | THRUST VORSCHUBKRAFT | 1350 N |
|  | WEIGHT GEWICHT | 16-21 Kg |

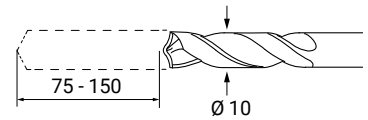

DRILLING CAPACITY IN STEEL R=60
BOHRLEISTUNG IN STAHL R=60

Ø 10

STROKE
HUB

75 mm
150 mm

TOOLHOLDER
WERKZEUGAUFNAHME

A = B12 DIN 238
F = DIN 55058 Ø 16
L = ER20

SPINDLE RPM (50HZ) / SPINDEL DREHZAHL

| | | | |
|---|------|----|----------------------------------|
| E | 400 | | CHAIN KETTE |
| F | 500 | 6P | |
| G | 600 | | |
| H | 800 | 6P | |
| I | 1000 | | |
| J | 1200 | | |
| K | 1500 | | |
| L | 1800 | 4P | TIMING BELT ZAHNRIEMEN |
| M | 2000 | | |
| N | 2400 | | |
| O | 3000 | 2P | |
| P | 3600 | | |
| Q | 4000 | | |
| R | 4500 | | |
| S | 5400 | | |
| T | 6400 | 2P | POLY - V BELT POLY - V RIEMEN |
| U | 7500 | | |
| V | 8400 | | |

DXP 10 /.. /.. /.. /.. /..

MOTOR / MOTOR

| | | | | | |
|-----|---|----|---|---------|----|
| 203 | = | 80 | - | 0,75 kW | 2P |
| 403 | = | 80 | - | 0,55 kW | 4P |
| 604 | = | 80 | - | 0,55 kW | 6P |

Max frame 80 / Max Größe 80

HYDROCHECK / HYDRAULIKBREMSE

HF50 = STROKE/ HUB 50 mm
HF75 = STROKE/ HUB mm
HF100 = STROKE/ HUB mm

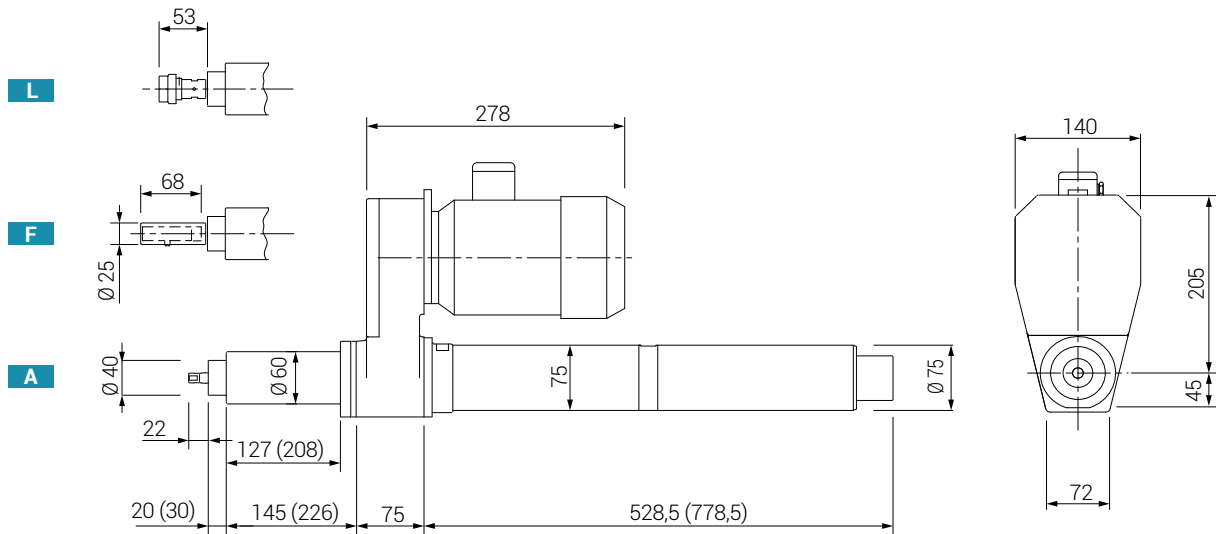

Dimension () are for the 150 mm stroke unit / (Quoten) = Einheit mit Hub 150

ACCESSORIES

(Page 40)

- Multi spindle heads
- Pneumatic peck feed device
- For brackets see 3D pictures

ZUBEHÖR

(Seite 40)

- Mehrspindelköpfe
- Pneumatische Entspäneinrichtung
- Zubehör siehe 3D Abbildung

