

● **Carriers - 3 base jaws**

- Carrier with central drill for irregular workpiece
- Built-in pneumatic cylinder and external collector

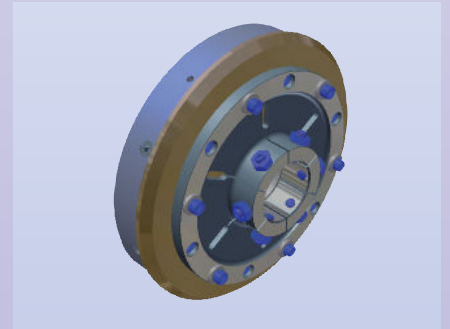

BASE SYSTEM									CARRIER WITH SCREWS						CARRIER WITH SECTORS					COMPLETE CODE		
Code	A	B	C	D	E H7	F	G	H	Code	I1 Max	L1	M1	O	N	Code	I2 Max	L2	M2	P	Q		
OX	G64.000OX	198	55	124	3x M8	140	3	37	G 1/8"	X1	G64.000OX1	20	150	25	7	6x M6	—	—	—	—	—	OX/X1
										X2	G64.000OX2	42	150	25	7	6x M6	—	—	—	—	—	OX/X2
										—	—	—	—	—	—	X3	G64.000OX3	25	150	26	13	13
OY	G64.000OY	130	51	82	4x M8	125	3	30	G 1/8"	—	—	—	—	—	Y1	G64.000OY1	19	98	—	9	—	OY/Y1
										Y2	G64.000OY2	31	98	21	6	4x M5	—	—	—	—	—	OY/Y2
										—	—	—	—	—	—	Z1	G64.000OZ1	40	220	38	21	17
OZ	G64.000OZ	278	50.5	200	6x M8	154	5	39	G 1/8"	Z2	G64.000OZ2	32	220	33	5	6x M6	—	—	—	—	—	OZ/Z2
										Z3	G64.000OZ3	46	220	27	7	6x M6	—	—	—	—	—	OZ/Z3
										Z4	G64.000OZ4	46	220	36	7	6x M6	—	—	—	—	—	OZ/Z4
										Z5	G64.000OZ5	60	220	37	9	6x M6	—	—	—	—	—	OZ/Z5
										—	—	—	—	—	—	—	Z6	G64.000OZ6	60	220	36	19

